

Installation Instructions / Warranty

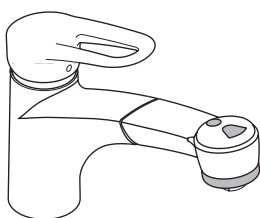

Metropol Kitchen Mixer
14837XX1

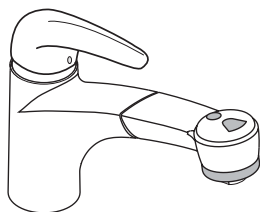

Monsoon Kitchen Mixer

hansgrohe



Ihr Online-Fachhändler für:

hansgrohe

- Kostenlose und individuelle Beratung
- Hochwertige Produkte
- Kostenloser und schneller Versand

- TOP Bewertungen
- Exzelerter Kundenservice
- Über 20 Jahre Erfahrung



E-Mail: info@unidomo.de | Tel.: 04621 - 30 60 89 0 | www.unidomo.de

Thank you for purchasing a Monsoon™ kitchen faucet. It is designed to give you many years of convenience reliability.

To save time and prevent aggravation, please take a few moments to read over these instructions **thoroughly** before removing the old faucet. Insure that you have the tools, supplies, and parts necessary to complete the installation, and that you purchase the correct items to adapt your existing water supplies.

Hansgrohe recommends that this faucet be installed by a licensed, professional plumber.

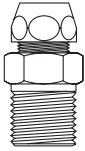

Important Note: This faucet includes 10mm compression by 1/2" MIP check valve/adapters for the hot and cold supplies. These **MUST** be used to insure that the drinking water supply is protected from backsiphonage.

Product Specifications:

Hole size in mounting surface	Minimum 1-1/2" Maximum 1-5/8"
Maximum mounting surface depth	2-3/8"
Flow rate	2.2 GPM
Maximum incoming water pressure	145 PSI
Recommended incoming water pressure	22 - 72.5 PSI
Recommended incoming hot water temp	120° - 140° F*
M3 cartridge with high temperature limit stop	

*Some governing bodies require that the water heater be set to 120° F or less. Please know and follow all applicable local codes when setting the temperature on the water heater.

Preparation for Installation:

Turn the water supplies off before removing the old faucet. **Be safe! HOT WATER CAN CAUSE DAMAGE TO YOUR PROPERTY, AND INJURY OR DEATH TO YOU!**

Flush the supply lines of debris before beginning installation.

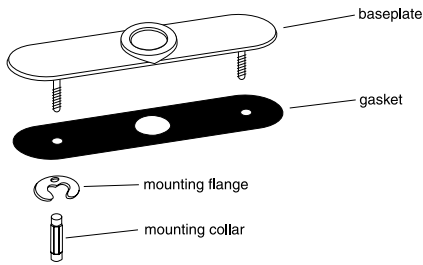

Install the faucet on the sink:

If the Monsoon kitchen mixer is to be used on a 3-hole kitchen sink, position the enclosed baseplate and gasket on the faucet deck. From under the sink, install the mounting flanges and tighten the mounting collars.

Leave the black rubber washer in place on the faucet. Remove the slide washer, metal washer, and collar nut from the faucet shank and place in a safe, convenient location. Feed the supply lines, handspray hose, and faucet shank through the hole in the baseplate and/or the faucet deck.

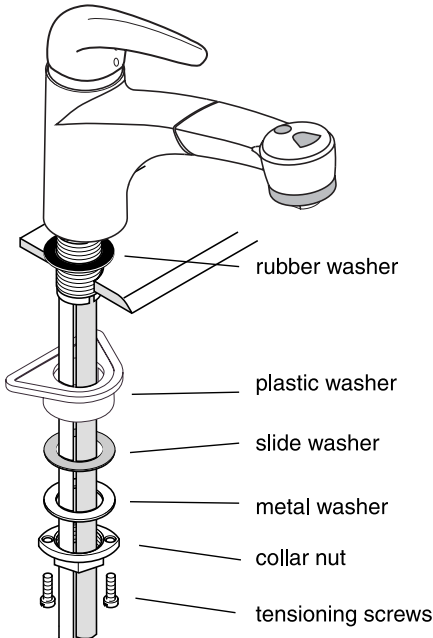

From underneath the sink, install the plastic washer, slide washer, and metal washer. Thread on the collar nut loosely.

If the total thickness of the mounting surface is greater than 1-3/8", omit the plastic washer.

From above the sink, inspect the placement of the faucet and baseplate. Reposition if necessary.

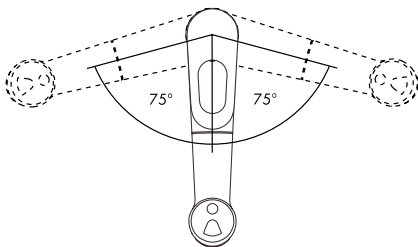

Check the swivel of the faucet spout - it should swivel equally to the right and to the left. If it appears to swivel more to one side than to the other, pivot the faucet body until the swivel is even.

When you are satisfied that everything is oriented properly, finish tightening the collar nut. Tighten the tensioning screws.

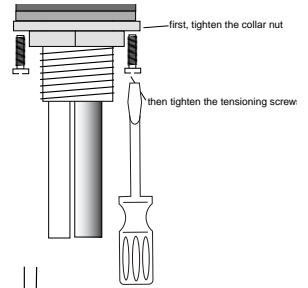

Install the water supplies:

Install your water supply hookup, carefully following the manufacturers instructions.

Thread the 1/2" MIP end of the check valve/adapter into the supply hook-up.

Remove the compression nut and washer from the check valve/adapter. Slide them over the end of the faucet supply hose. Insure that the metal side of the compression washer faces away from the check valve (toward the faucet body)

Insert the hose end into the check valve/adapter. Tighten the nut by hand, then complete with a wrench.

Repeat with the other check valve / adapter.

Connect the handspray hose:

Loosen the compression fitting on the end of the flexible handspray hose. Slide it onto the end of the metal hose supply tube. Tighten wrench tight.

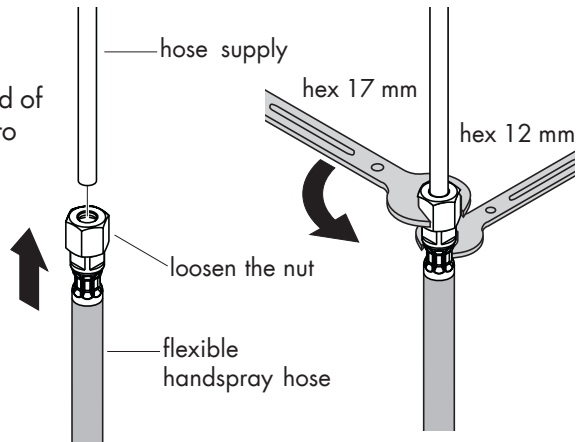

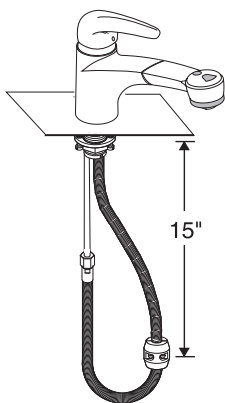

Install the hose weight:

Proper installation of the hose weight will insure that the handspray hose retracts smoothly.

On the handshower side of the hose, use a ruler to measure 15" down from the body of the faucet. Install the hose weight at this point.

Pull out on the handspray, and guide it back into the faucet. It should move easily and retract smoothly. Reposition the hose weight if necessary.

Turn on the water. Check all connections for leaks. Check the faucet for proper operation.

Using the faucet:

Tilt the handle up to turn on the water. Pivoting the handle to the left makes the water warmer, to the right, cooler. Push the handle down to turn the water off. Pressing the front button on the handspray activates the spray mode. Pressing the rear button activates the stream mode. The handspray can be pulled "out" from the body of the faucet approximately 15 inches.

Replacement Parts:

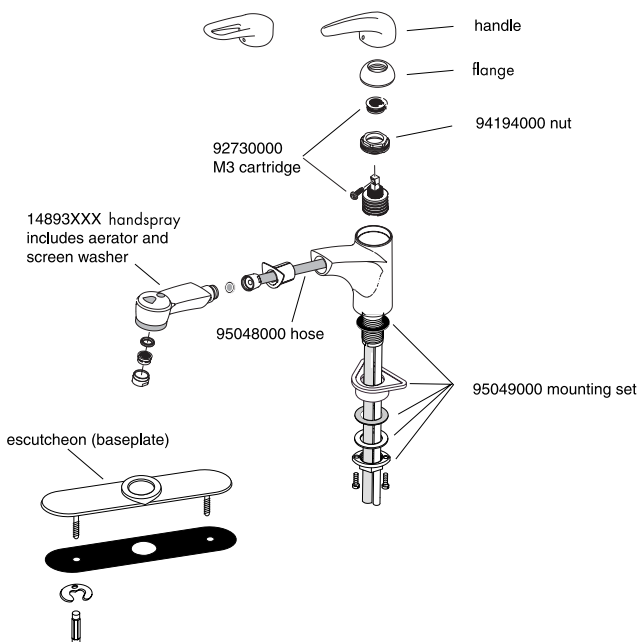

Troubleshooting Information:

Problem	Possible Cause	Solution
too little water	aerator clogged	remove and clean aerator
	screen washer clogged	remove and clean screen washer
faucet drips	debris in cartridge	remove and flush cartridge
	o-rings damaged	replace o-rings
too little hot water	high temperature limit stop set improperly	reset high temperature limit stop

Cleaning Recommendation for Hansgrohe Products

Modern faucetry and shower products utilize a combination of materials to comply with the needs of the market with regard to design and functionality.

To avoid damage, it is necessary to use some caution when cleaning. Damage caused by improper treatment is not covered under the Hansgrohe warranty.

Cleaning Materials for Faucets and Showers

- To remove lime scale, use only products made specifically for that purpose, such as Lime-Away or CLR. Always follow the manufacturer's instructions when using.
- Do not use cleaners that contain hydrochloric, formic, acetic, or phosphoric acids, as these will cause considerable damage to finishes and to plastic components.
- Never mix cleaning materials.
- Never use cleaners containing abrasives. Do not use abrasive cleaning cloths, pads, or sponges.

Cleaning Procedures

- Clean your faucets and shower products as and when required. Regular cleaning will prevent scale buildup and water spotting.
- Follow the label instructions. Do not allow any cleaner to remain on the product for longer than necessary.
- When using spray cleaners, spray first onto a sponge or cloth – do not spray directly onto the product.
- After cleaning, rinse thoroughly with clear water to remove any cleaner residue.

Important

- Soap and shampoo residue can also cause damage to the product. Rinse well with clean water after use.
- If the surface is already damaged, harsh cleaning materials will cause further damage.

Set the High Temperature Limit Stop (optional)

Turn off the water at the supply stops.

Close the drain or cover it with a cloth. Gently pry off the screw cover. Put it aside in a safe place. Use a 4mm hex wrench to loosen the handle screw (4 revolutions). Remove the handle, and the decorative flange underneath.

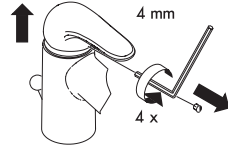

Remove the nut.



Remove the handle screw from the stem of the cartridge.

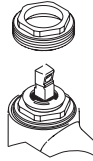

Remove the high temperature limit stop.

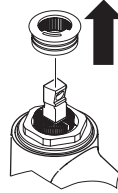

Replace the high temperature limit stop so that the pin is in the desired notch. The temperatures marked on the diagram assume an incoming hot water temperature of 140° F and an incoming cold water temperature of 50° F, and a water pressure of 45 psi. Your results will vary.

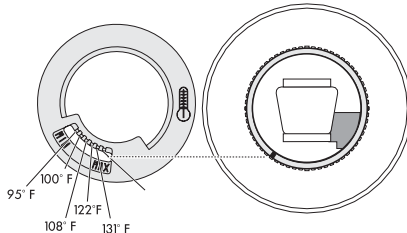
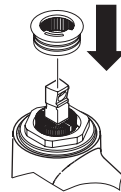

Replace the nut, nut cover, screw, and handle.

Cleaning Recommendation for Hansgrohe Products

Modern faucetry and shower products utilize a combination of materials to comply with the needs of the market with regard to design and functionality.

To avoid damage, it is necessary to use some caution when cleaning. Damage caused by improper treatment is not covered under the Hansgrohe warranty.

Cleaning Materials for Faucets and Showers

- To remove lime scale, use only products made specifically for that purpose. Always follow the manufacturer's instructions when using.
- Do not use cleaners that contain hydrochloric, formic, acetic, or phosphoric acids, as these will cause considerable damage to finishes and to plastic components.
- Never mix cleaning materials.
- Never use cleaners containing abrasives. Do not use abrasive cleaning cloths, pads, or sponges.

Cleaning Procedures

- Clean your faucets and shower products as and when required. Regular cleaning will prevent scale buildup and water spotting.
- Follow the label instructions. Do not allow any cleaner to remain on the product for longer than necessary.
- When using spray cleaners, spray first onto a sponge or cloth – do not spray directly onto the product.
- After cleaning, rinse thoroughly with clear water to remove any cleaner residue.

Important

- Soap and shampoo residue can also cause damage to the product. Rinse well with clean water after use.
- If the surface is already damaged, harsh cleaning materials will cause further damage.

Limited Lifetime Consumer Warranty

This product has been manufactured and tested to the highest quality standards by Hansgrohe, Inc. ("Hansgrohe"). This warranty is limited to Hansgrohe products which are purchased by a consumer in the United States after March 1, 1996, and installed in either the United States or Canada.

WHO IS COVERED BY THE WARRANTY

This warranty extends to the original consumer purchaser only.

WHAT IS COVERED BY THE WARRANTY

This warranty covers only your Hansgrohe manufactured product. Hansgrohe warrants this product against defects in material or workmanship as follows: Hansgrohe will repair at no charge for parts only or, at its option, replace any product or part of the product which proves defective because of improper workmanship and/or material, under normal installation, use, service and maintenance. If Hansgrohe is unable to provide a replacement and repair is not practical or cannot be timely made, Hansgrohe may elect to refund the purchase price in exchange for the return of the product.

LENGTH OF WARRANTY

Replacement or repaired parts of products will be covered for the term of this warranty as stated in the following two sentences. If you are a consumer who purchased the product for use primarily for personal, family, or household purposes, this warranty extends for as long as you own the product and the home in which the product is installed. If you purchased the product for use primarily for any other purpose, including, without limitation, a commercial purpose, this warranty extends only (i) for 1 year, with respect to Interaktiv and Retroaktiv products, and (ii) for 5 years, with respect to AXOR, ShowerPower and Pharo products.

THIS WARRANTY DOES NOT COVER, AND HANSGROHE WILL NOT PAY FOR:

- A. Conditions, malfunctions or damage not resulting from defects in material or workmanship.
- B. Conditions, malfunctions or damage resulting from (1) improper installation, improper maintenance, misuse, abuse, negligence, accident or alteration, or (2) the use of abrasive or caustic cleaning agents or "no rinse" cleaning products, or the use of the product in any manner contrary to the product instructions.
- C. Labor or other expenses for the disconnection or return of the product for warranty service, or for installation or reinstallation of the product.
- D. Accessories or related products not manufactured by Hansgrohe.

TO OBTAIN WARRANTY SERVICE

Contact your Hansgrohe retailer, or write to Technical Service at:

Hansgrohe Inc.
1492 Bluegrass Lakes Parkway
Alpharetta GA 30004

Or, call Hansgrohe toll-free at (800) 334-0455.

In requesting warranty service, you will need to provide

1. The sales receipt or other evidence of the date and place of purchase.
2. A description of the problem.
3. Delivery of the product or the defective part, postage prepaid and carefully packed and insured, to Hansgrohe Inc. 1492 Bluegrass Lakes Parkway, Alpharetta, Georgia 30004, Attention: Technical Service, if required by Hansgrohe.

When warranty service is completed, any repaired or replacement product or part will be returned to you postage prepaid.

EXCLUSIONS AND LIMITATIONS

REPAIR OR REPLACEMENT (OR, IN LIMITED CIRCUMSTANCES, REFUND OF THE PURCHASE PRICE) AS PROVIDED UNDER THIS WARRANTY IS THE EXCLUSIVE REMEDY OF THE PURCHASER. HANSGROHE NEITHER ASSUMES NOR AUTHORIZES ANY PERSON TO CREATE FOR IT ANY OBLIGATION OR LIABILITY IN CONNECTION WITH THIS PRODUCT.

HANSGROHE SHALL NOT BE LIABLE TO PURCHASER OR ANY PERSON FOR ANY INCIDENTAL, SPECIAL, OR CONSEQUENTIAL DAMAGES, ARISING OUT OF BREACH OF THIS WARRANTY OR ANY IMPLIED WARRANTY (INCLUDING MERCHANTABILITY).

Some States do not allow the exclusion or limitation of incidental or consequential damages, so the above limitation or exclusion may not apply to you.

This warranty gives you specific legal rights, and you may have other rights which vary from State to State.

You may be required by law to give us a reasonable opportunity to correct or cure any failure to comply before you can bring any action in court against us under the Magnuson-Moss Warranty Act.

PRODUCT INSTRUCTIONS AND QUESTIONS

Upon purchase or prior to installation, please carefully inspect your Hansgrohe product for any damage or visible defect. Prior to installing, always carefully study the enclosed instructions on the proper installation and the care and maintenance of the product. If you have questions at any time about the use, installation, or performance of your Hansgrohe product, or this warranty, please call or write to us at the toll-free number and address printed above.



hansgrohe

AXOR | PHÂRO

Hansgrohe Inc. 1490 Bluegrass Lakes Parkway Alpharetta GA 30004
Phone 770 360 9880 Internet www.Hansgrohe-USA.com

04/2005
9.09286.01