

Installation Instructions / Warranty

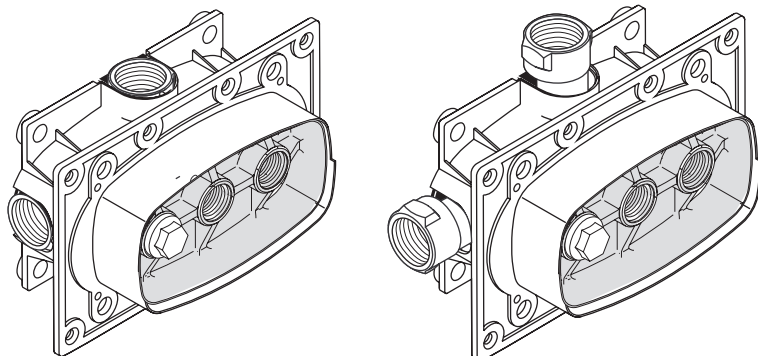

Ecostat

15373181 (1/2")

15374181 (3/4")

hansgrohe



Ihr Online-Fachhändler für:

hansgrohe

- Kostenlose und individuelle Beratung
- Hochwertige Produkte
- Kostenloser und schneller Versand

- TOP Bewertungen
- Exzelerter Kundenservice
- Über 20 Jahre Erfahrung



E-Mail: info@unidomo.de | Tel.: 04621 - 30 60 89 0 | www.unidomo.de

Hansgrohe Ecostat™ I-Box Rough Valve

15373181 (1/2")

15374181 (3/4")

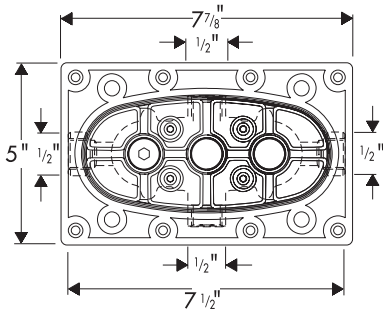
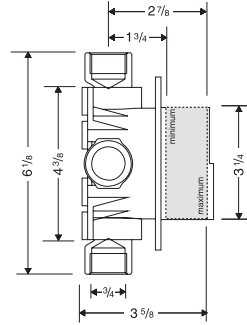
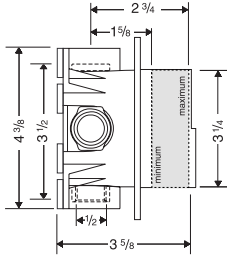

15373181

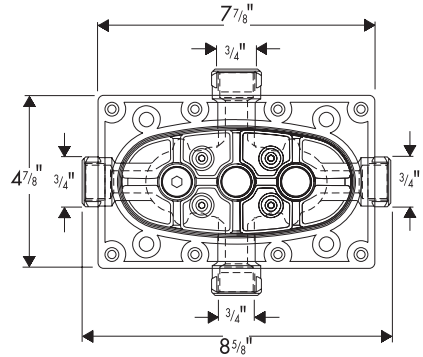

15374181

Technical Information

Max. incoming water pressure 145 psi
 Recommended water pressure 45 - 80 psi
 Recommended hot water temp 120°F - 140°F*
 Safety stop 100°F

This rough must be completed with a Hansgrohe Ecostat™ or EcoMax™ trim kit (sold separately). The thermoelement, which incorporates the thermostat cartridge, check valves, and service stops is included with the trim kit to prevent loss or damage at the jobsite.

Flow rate @ 44 psi

with Ecostat Universal trim 13.2 gpm
 with EcoMax trim 20 gpm

* Follow all applicable local plumbing codes when setting the temperature on the water heater. In Massachusetts, the water heater may be set no higher than 112° F

Installation Considerations

For best results, this unit should be installed by a licensed professional plumber.

Large differences in pressure between the hot and cold supplies must be balanced or the valve will not work properly.

The Ecostat™ thermostatic mixer controls water temperature only. It does not control or direct the flow of water.

If the installation is performed in freezing weather, or where freezing conditions may occur prior to building completion, drain all water from the plumbing system to prevent freeze damage to the Ecostat™ rough and/or the piping system.

Do not solder the supply or outlet pipes directly to this rough valve.

Do not use a diverter tub spout with the Ecostat™.

Know and follow all applicable local plumbing codes when installing and pressure testing this valve.

The thermoelement (included with the trim kit) incorporates a high temperature limit stop which may be reset to comply with local codes.

Shower System Layout

The Ecostat™ thermostatic mixer controls the water temperature only. It does not have an “off” position. Volume control must be installed for each outlet. The following items may be used:

Volume control valves 13974181 (1/2”) and 13975181 (3/4”)

Fixfit stop wall outlet (various styles) – volume control and wall outlet for handshower

Trio stop diverter 15980181 – provides volume control and diverter for two functions.

The Quattro diverter (13932181) does not have an “off” position. A volume control valve must be installed between the Ecostat and the Quattro.

Pipe all shower functions from the top outlet port. The bottom outlet port should be used for a tub filler only. If shower functions are piped from both outlet ports, then run simultaneously, an unacceptable temperature difference will result.

DO NOT use a diverter tub spout with the Ecostat™. If a tub/shower is desired, pipe a volume control and a tub spout from the bottom outlet port, or pipe the tub spout from one of the outlet ports on a Trio Stop Diverter, or a Quattro diverter.

Allow sufficient space between the valves for the trim plates. The positions of the valves can be adjusted for the tile pattern.

Suggested Layouts

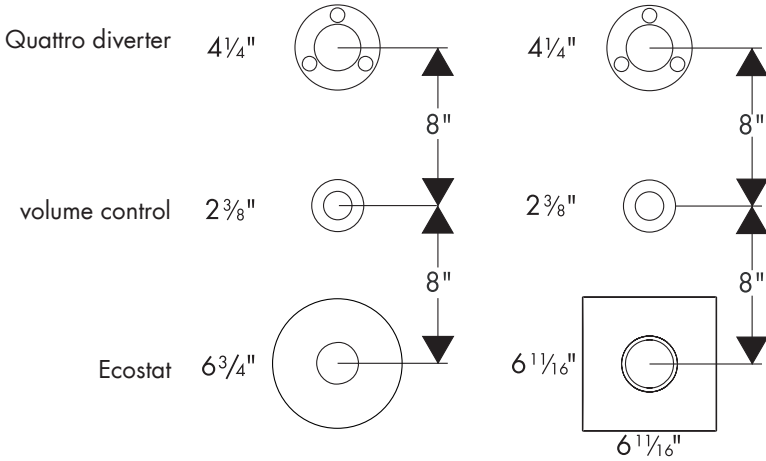

Note: the sizes of the trim plates shown here are subject to change.

2-function system with two volume controls.

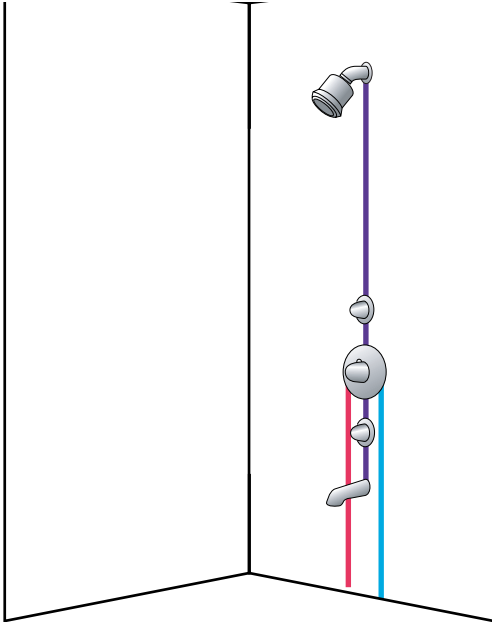

2-function system with Trio Stop diverter.

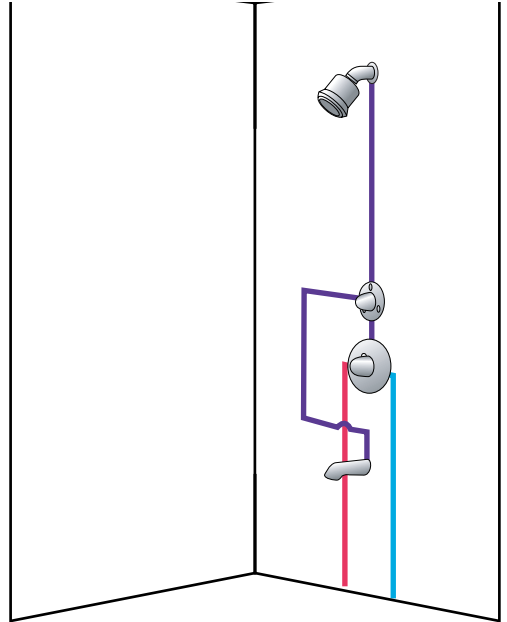

3-function system with Ecostat, volume control, and Quattro diverter

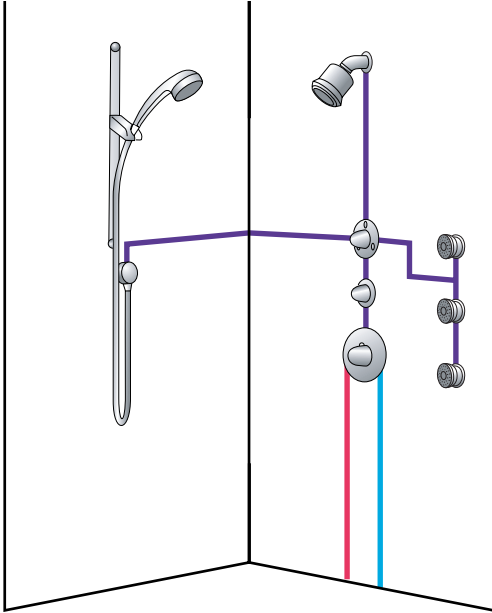

3-function system with Ecostat and three volume control valves.

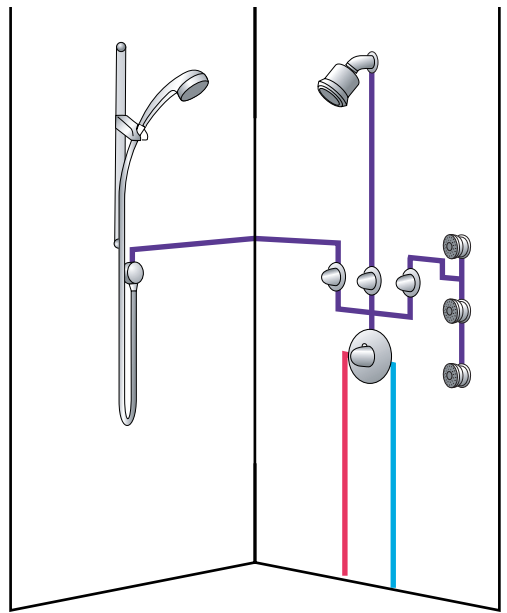

Note: these diagrams are not to scale.

Installation

For proper operation of the Ecostat™ valve, the hot supply should be plumbed into the hot outlet port, and the cold supply should be plumbed into the cold outlet port.

The hot and cold inlet ports are marked three ways - red and blue dye on the brass, "hot" and "cold" stamped on the installation box, and "hot" and "cold" printed on the wall depth sticker on the plaster shield portion of the installation box.

The inlet and outlet ports are threaded for male NPT fittings. **Do not sweat directly to the rough.** Sweat the pipes to adapters.

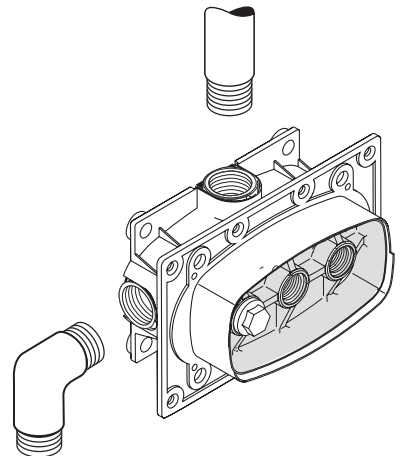

If only the top outlet port is to be used, seal the bottom outlet port with a plug (not included).

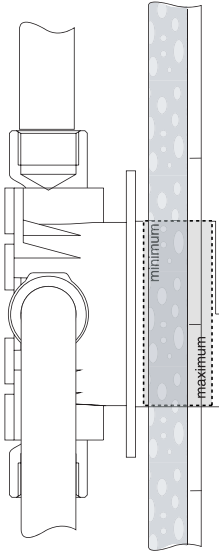

warm	ACHTUNG! Thermostat ohne Absperrung	↑	kalt	
hot	Attention! Thermostat without shut-off valve	MIN	cold	
chaud	Attention! Thermostat sans robinet d'arrêt	Fliesenvorderkante Wall Surface Face avant du carrelage	↓	froid
		MAX		

To insure proper fit of the trim, the outside surface of the finished wall must fall between the "MIN" and "MAX" markings on the wall depth sticker.

Secure the valve as necessary. If desired, and if space permits, the i-box may be used as a screw-in flange.

Once the volume controls are installed, it is safe to pressurize the system. The plastic flush unit is ported so that crossflow cannot occur.

Do not remove the plastic i-box. Do not remove the flush unit until the trim is to be installed.

Flush and Pressure Test the System with the Flush unit

The hot and cold supplies must be flushed prior to installation of the thermoelement. Damage to the thermoelement caused by debris is not covered under the Hansgrohe warranty.

The flush unit is ported so that the cold supply flushes through the outlet port(s). The hot supply flushes through the port in the front of the flush unit occupied by a white plastic plug.

Prior to pressurizing the system, remove the white plastic plug from the front of the flush unit. Install hose bibbs (not included) to the opening in the flush unit and to the outlet(s). Install hoses. Position the hoses so that, when the system is pressurized, the water will cause no damage.

Pressurize the system. Allow the supplies to flush for at least 5 minutes.

Depressurize the system. Remove the hose bibbs. Reinstall the plastic plug in the flush unit.

Plug the outlet(s). Pressurize the system. Check all connections for leaks.

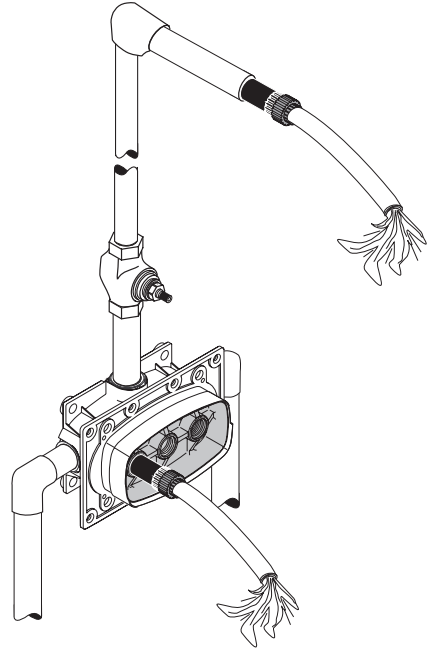

Finish the wall

The wall should be finished up to the plaster shield portion of the i-box, as shown.

The plaster shield will be cut off so that it extends 1/16" outside the finished wall when the trim kit is installed.

Do not remove the flush unit until directed to by the trim kit installation instructions.

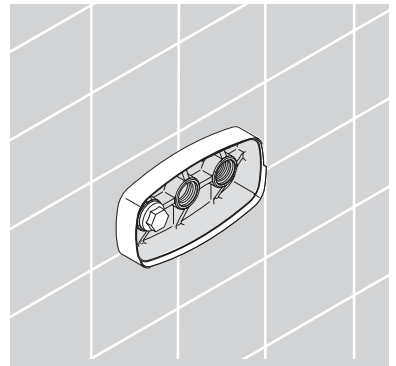

Replacement Parts

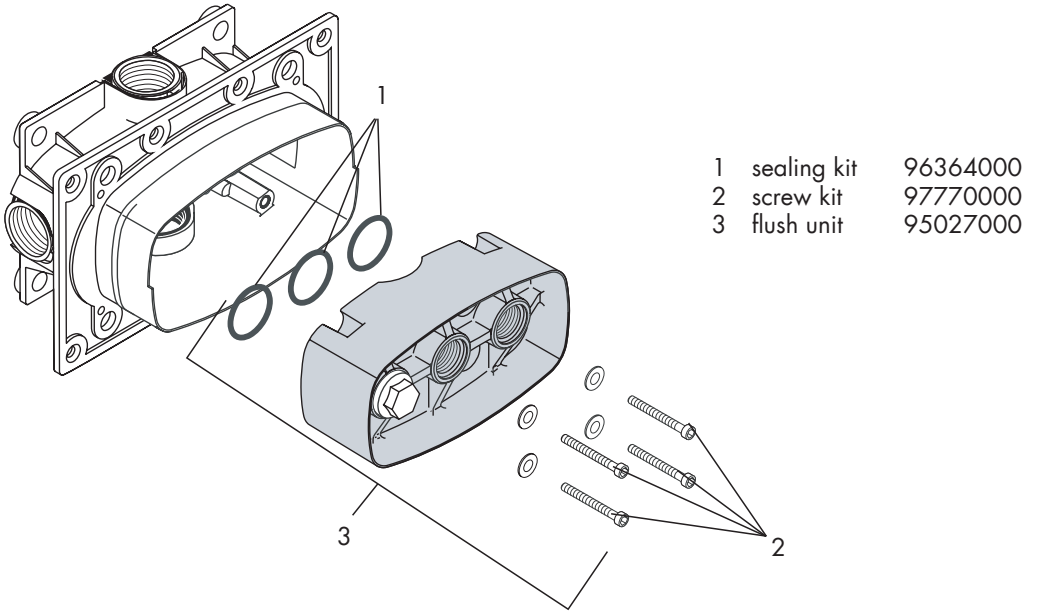

Cleaning Recommendation for Hansgrohe Products

Modern faucetry and shower products utilize a combination of materials to comply with the needs of the market with regard to design and functionality.

To avoid damage, it is necessary to use some caution when cleaning. Damage caused by improper treatment is not covered under the Hansgrohe warranty.

Cleaning Materials for Faucets and Showers

- To remove lime scale, use only products made specifically for that purpose. Always follow the manufacturer's instructions when using.
- Do not use cleaners that contain hydrochloric, formic, acetic, or phosphoric acids, as these will cause considerable damage to finishes and to plastic components.
- Never mix cleaning materials.
- Never use cleaners containing abrasives. Do not use abrasive cleaning cloths, pads, or sponges.

Cleaning Procedures

- Clean your faucets and shower products as and when required. Regular cleaning will prevent scale buildup and water spotting.
- Follow the label instructions. Do not allow any cleaner to remain on the product for longer than necessary.
- When using spray cleaners, spray first onto a sponge or cloth – do not spray directly onto the product.
- After cleaning, rinse thoroughly with clear water to remove any cleaner residue.

Important

- Soap and shampoo residue can also cause damage to the product. Rinse well with clean water after use.
- If the surface is already damaged, harsh cleaning materials will cause further damage.

Limited Lifetime Consumer Warranty

This product has been manufactured and tested to the highest quality standards by Hansgrohe, Inc. ("Hansgrohe"). This warranty is limited to Hansgrohe products which are purchased by a consumer in the United States after March 1, 1996, and installed in either the United States or Canada.

WHO IS COVERED BY THE WARRANTY

This warranty extends to the original consumer purchaser only.

WHAT IS COVERED BY THE WARRANTY

This warranty covers only your Hansgrohe manufactured product. Hansgrohe warrants this product against defects in material or workmanship as follows: Hansgrohe will repair at no charge for parts only or, at its option, replace any product or part of the product which proves defective because of improper workmanship and/or material, under normal installation, use, service and maintenance. If Hansgrohe is unable to provide a replacement and repair is not practical or cannot be timely made, Hansgrohe may elect to refund the purchase price in exchange for the return of the product.

LENGTH OF WARRANTY

Replacement or repaired parts of products will be covered for the term of this warranty as stated in the following two sentences. If you are a consumer who purchased the product for use primarily for personal, family, or household purposes, this warranty extends for as long as you own the product and the home in which the product is installed. If you purchased the product for use primarily for any other purpose, including, without limitation, a commercial purpose, this warranty extends only (i) for 1 year, with respect to Interaktiv and Retroaktiv products, and (ii) for 5 years, with respect to AXOR, ShowerPower and Pharo products.

THIS WARRANTY DOES NOT COVER, AND HANSGROHE WILL NOT PAY FOR:

- A. Conditions, malfunctions or damage not resulting from defects in material or workmanship.
- B. Conditions, malfunctions or damage resulting from (1) improper installation, improper maintenance, misuse, abuse, negligence, accident or alteration, or (2) the use of abrasive or caustic cleaning agents or "no rinse" cleaning products, or the use of the product in any manner contrary to the product instructions.
- C. Labor or other expenses for the disconnection or return of the product for warranty service, or for installation or reinstallation of the product.
- D. Accessories or related products not manufactured by Hansgrohe.

TO OBTAIN WARRANTY SERVICE

Contact your Hansgrohe retailer, or write to Technical Service at:

Hansgrohe Inc.
1492 Bluegrass Lakes Parkway
Alpharetta GA 30004

Or, call Hansgrohe toll-free at (800) 334-0455.

In requesting warranty service, you will need to provide

1. The sales receipt or other evidence of the date and place of purchase.
2. A description of the problem.
3. Delivery of the product or the defective part, postage prepaid and carefully packed and insured, to Hansgrohe Inc. 1492 Bluegrass Lakes Parkway, Alpharetta, Georgia 30004, Attention: Technical Service, if required by Hansgrohe.

When warranty service is completed, any repaired or replacement product or part will be returned to you postage prepaid.

EXCLUSIONS AND LIMITATIONS

REPAIR OR REPLACEMENT (OR, IN LIMITED CIRCUMSTANCES, REFUND OF THE PURCHASE PRICE) AS PROVIDED UNDER THIS WARRANTY IS THE EXCLUSIVE REMEDY OF THE PURCHASER. HANSGROHE NEITHER ASSUMES NOR AUTHORIZES ANY PERSON TO CREATE FOR IT ANY OBLIGATION OR LIABILITY IN CONNECTION WITH THIS PRODUCT.

HANSGROHE SHALL NOT BE LIABLE TO PURCHASER OR ANY PERSON FOR ANY INCIDENTAL, SPECIAL, OR CONSEQUENTIAL DAMAGES, ARISING OUT OF BREACH OF THIS WARRANTY OR ANY IMPLIED WARRANTY (INCLUDING MERCHANTABILITY).

Some States do not allow the exclusion or limitation of incidental or consequential damages, so the above limitation or exclusion may not apply to you.

This warranty gives you specific legal rights, and you may have other rights which vary from State to State.

You may be required by law to give us a reasonable opportunity to correct or cure any failure to comply before you can bring any action in court against us under the Magnuson-Moss Warranty Act.

PRODUCT INSTRUCTIONS AND QUESTIONS

Upon purchase or prior to installation, please carefully inspect your Hansgrohe product for any damage or visible defect. Prior to installing, always carefully study the enclosed instructions on the proper installation and the care and maintenance of the product. If you have questions at any time about the use, installation, or performance of your Hansgrohe product, or this warranty, please call or write to us at the toll-free number and address printed above.

hansgrohe

Hansgrohe, Inc. • 1490 Bluegrass Lakes Parkway • Alpharetta, GA 30004
Tel. 770 360-9880 • Fax 770 360 9887

www.hansgrohe-USA.com